

TNC REVERSE POLARITY MATING DIMENSIONS

INTERFACE MATING DIMENSIONS TNC Reverse Polarity

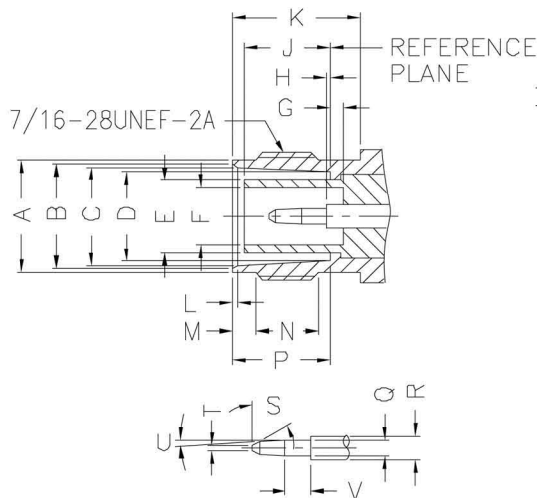
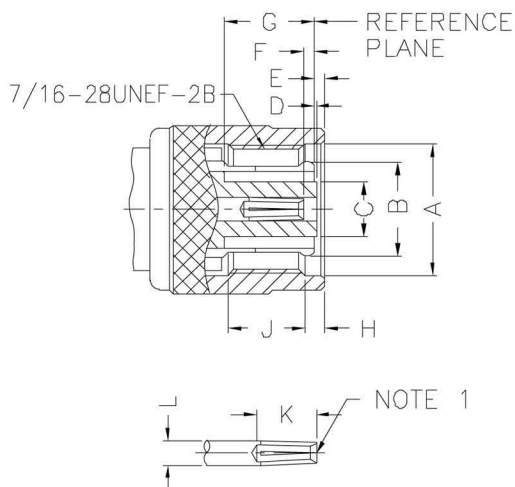

PLUG		
Letter	Millimeters	
	Minimum	Maximum
A	11.18	-
B	Flared To Meet Good Electrical Contact	
C	-	4.72
D	0.03	0.53
E	-	1.98
F	0.61	1.12
G	7.52	-
H	1.60	-
J	3.96	-
K	4.95	-
L	2.06	2.21

JACK		
Letter	Millimeters	
	Minimum	Maximum
A	9.60	9.70
B	8.79	9.04
C	8.31	8.46
D	8.10	8.15
E	-	6.65
F	4.83	-
G	0.53	1.04
H	0.00	0.25
J	-	7.52
K	10.52	-
L	0.38	0.76
M	1.73	2.24
N	4.75	-
P	8.31	8.51
Q	1.32	1.37
R	2.06	2.21
S	55.00	65.00
T	-	0.64
U	1.00	4.00
V	1.98	-
V	1.00	4.00
W	1.98	-

Note 1 : I.D. to meet VSWR and contact resistance when mated with 1.32/1.37 mm dia. pin.